

EAN CODE : 3760244880253

12 V REMOTE-SENSING ALE1205



- PRECISE** : Switching power supply offering a ripple < 3 mV rms.
 - Output voltage adjustable from 10 to 15 V
- SMALL** : Modular,
- EASY** : Direct DIN rail or panel mounting.
- PROTECTED** : against short circuits and reverse polarity.
- RESISTANT TO SHOCK**

**60 WATTS**

12 V (Adj. 10 to 15 V)

5 A

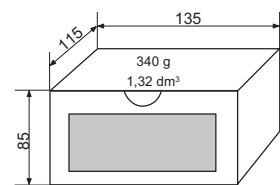
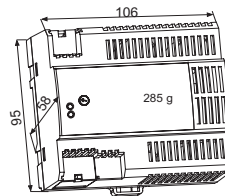

Specifications

Voltage

- Floating outputs on spring terminal block with levers for 2,5 mm² (AWG 12) wires.
- Output voltage : adjustable from 10 to 15 V.
- Regul : < 20 mV for a load variation from 0 to 100%
< 2 mV for a line variation from -10 to +10%.
- Ripple : < 3 mV rms including:
< 2 mV peak to peak of the signal at 100 kHz
< 4 mV peak to peak of the signal at 100 Hz
< 10 mV peak to peak of switching spikes
- Hold-up time : 25 ms at half load and 12 ms at full load (190 V line input).
- Indicator : green power-on LED indicator.
Overheat or overcurrent red LED "status" indicator

Current

- Max I : 5,5 A in short circuit condition.
5 A from 10 to 12 V
4 A to 15 V

Power

- Max output power : 60 W.

Protection

- Short circuit protection, by current limit.
- Against overcurrent on primary circuit by fuse.
- Against overtemperature, by thermal shutdown.
- Cover on input output terminal block.

Remote sensing

- Correction of the voltage drop in the wires (4 wires method)
- Input on spring terminal block with levers for 2,5 mm² wires (AWG12)
- Correction : Max 3 V (1,5 V per wire)
- Ripple : < 30 mV for a load variation from 0 to max.

Other specifications

- Safety : Class II, Safety Extra Low Voltage (SELV),
complies with EN 61010-1, EN 61010-2-201 and EN 62368-1.
- EMC : Complies with EN 61000-6-2 and EN 61000-6-4.
- Overvoltage Category : II ; Pollution Degree : 2.
- Installation altitude : < 2000 m.
- Protection level : IP 30.
- Operating temperature : from -25 to +60 °C ; derating : 1 W/°C from +40 °C
- Input voltage : 190 to 264 Volts, 50/60 Hz.
- Mains input : spring terminal block with levers for 2,5 mm², (AWG 12) wires.
- Power consumption : 74 W max.
- Dielectric strength: 3000 VAC from input to output.
- Presentation : modular polycarbonate case (6 x 17,5 mm) screenprinted.
- Mounting : Clips package integrated in modular case for DIN rails
profile 35x7,5 mm or 35x15 mm.
Removable wall mouting integrated to the case for 4 mm screws.